

Soils Map

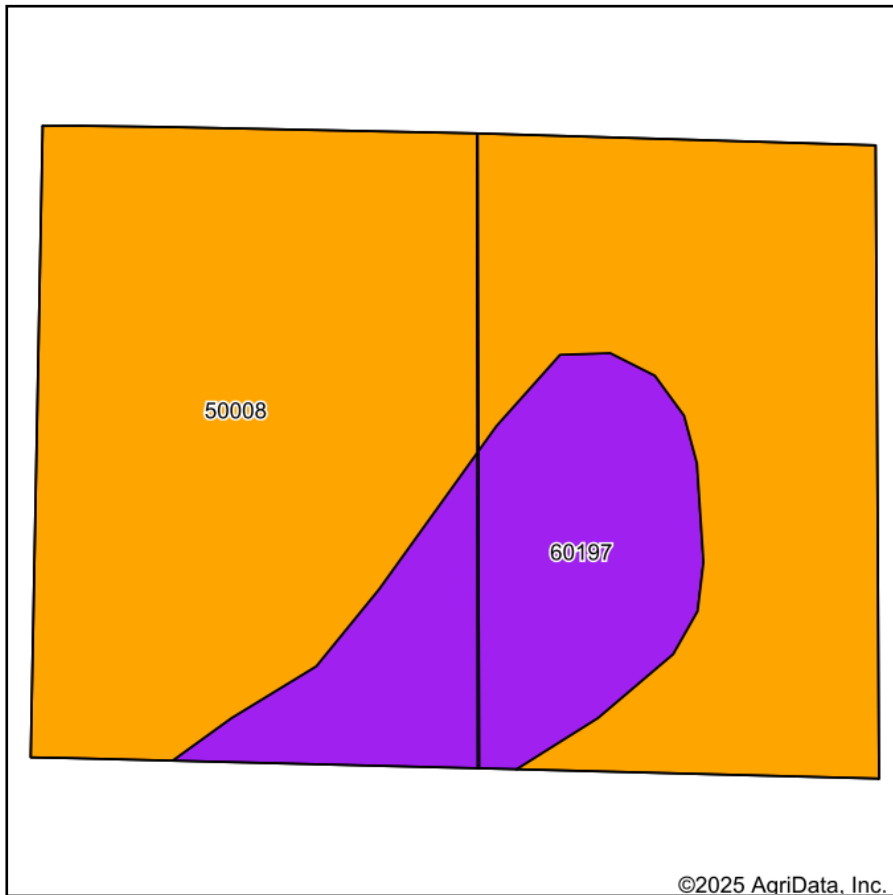

©2025 AgriData, Inc.

Soils data provided by USDA and NRCS.

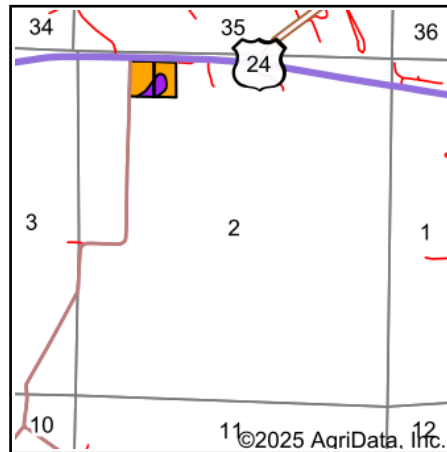

State: **Missouri**
 County: **Randolph**
 Location: **2-53N-15W**
 Township: **Salt Springs**
 Acres: **10.39**
 Date: **3/6/2025**



Area Symbol: MO175, Soil Area Version: 25

Code	Soil Description	Acres	Percent of field	Non-Irr Class Legend	Non-Irr Class *c	Alfalfa hay Tons	Caucasian bluestem Tons	Common bermudagrass Tons	Corn Bu	Orchardgrass red clover Tons	Soybeans Bu	Tall fescue Tons	Warm season grasses Tons	*n NCCPI Soybeans	
50008	Keswick silt loam, 5 to 9 percent slopes, eroded	8.18	78.7%		IIle									47	
60197	Reger-Gosport complex, 14 to 35 percent slopes	2.21	21.3%		Vlle	3	6	3	7	5	2	4	6	13	
Weighted Average						3.85	0.6	1.3	0.6	1.5	1.1	0.4	0.9	1.3	*n 39.8

*n: The aggregation method is "Weighted Average using all components"

*c: Using Capabilities Class Dominant Condition Aggregation Method

Soils data provided by USDA and NRCS.